

Data Sheet

Type Number 20390
Designation IEC SR1130W
System Silver Oxide / Zinc /
 NaOH - Electrolyte



Nominal Voltage 1,55 V
Typical Capacity C 59 mAh
 Load 5.6 kOhm, at 20°C down to 1.2 V

Weight (approx.) 1,16 g
Volume 0,26 ccm
Coding..... Date of Manufacturing
 Month/Year

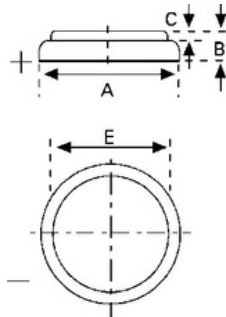

Temperature Ranges min max.
 Storage 0°C 60°C
 Discharge 0°C 60°C*

Dimensions min max.
 Diameter (A) 11,40 11,60
 Height (B) 2,80 3,05
 Shoulder Diameter[E]..... 6,00
 Shoulder Height [C]..... 0,08

Typical Capacities (at 20°C)

Discharge Type	Load	End Voltage:	1.2 V
Continuous	5600 \square	Time:	227 h
24h/d,7d/w		Capacity [mAh]:	59
Current [μ A]:		Energy [mWh]:	87

* Contact VARTA if the application is intended to be outside the range of 0°C to +60°C.

*Information and contents in this data sheet are for reference purpose only.
 They do not constitute any warranty or representation and are subject to change without notice.
 For most current information and further details, please contact your VARTA representative.*